

PANAGET

manufacture française de parquet
DEPUIS 1929



No 1001184

FRENCH OAK BOIS FLOTTÉ, CBM 141 TONGUE & GROOVE / 10 MM

Characteristics

Species: French oak **From:** France

Finish: Bois Flotté - brushed matt oiled with unfinished aspect / Hard wax oil - Gloss : 4/8

Grading : Light and dark wood, black knots, filled knots, partially opened knots, discolouration, black marks, filled cracks, sapwood.

Design

Wall panelling wide single plank made under the patent EN 13489

Tongue & Groove

1 dual & single-stave plank (mm) = 2005 or 1600 + 405 or 1505 + 500 or 1305 + 700
or 1205 + 800 or 1005 + 1000

Description

Width: 141 mm

Length: 2005 mm, dual & single-stave plank

Thickness: 10 mm

Top layer: 2.0 mm

Core: HDF*

Counterbalance: unrolled wood

Profile 2 bevelled ship-lap profile (2.5 mm)

* High Density Fiber Board

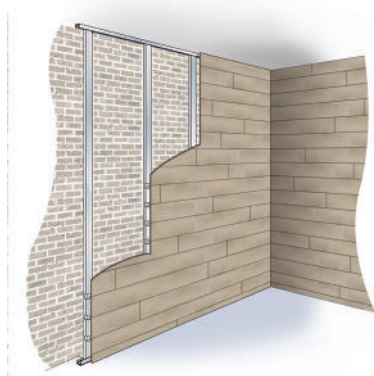

Packaging

Sqm/pack: 1.98 (7 strips)

Pack/pallet: 30

Sqm/pallet: 59.40

Weight/sqm: 8.1 kg

Weight/pallet: 481.14 kg

Installation method

Fixing to a metal frame (such as F530 or S47) using mounting clip patented by Panaget (tongue and groove calibrated).

Fixing to a wood frame, using traditional brackets.

Three different ways to install your wall panelling:

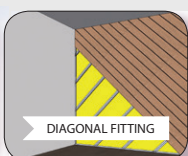
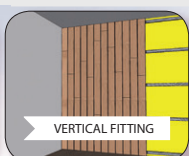

Patent-Pending
FR2988753



* Emissions of volatile substances which could be toxic if inhaled. These are rated on a scale from A+ (very low) to C (high).

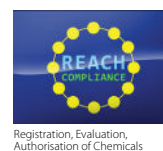

PANAGET - 3 rue d'Orgères - 35230 Bourgarré - FRANCE
tel: +33 (0)2 99 05 77 77 // fax: +33 (0)2 99 57 73 55 // www.panaget.com

DECLARATION OF PERFORMANCE

No 1001184



Unique identification code of the product-type: CBM Tongue & Groove, 10 mm, French oak

Intended use/es: Wall panelling

Fixing to a metal frame system (F530 or S47)

Manufacturer: PANAGET - 3 rue d'Orgères 35230 Bourgbarré / FRANCE

System/s of Assessment and Verification of Constancy of Performance: No3

Harmonised standard: EN 14986+A1: 2015

Declared performance:

Essential features	Performance	Appropriate Technical Documentation and/or Specific Technical Documentation
Reaction to fire: - Intended use, fitting mode	D-s1, d0 CBM installation Substrate classification $\leq D$ / Insulation $\leq A2$	EN 13501-1 Test lab notified no. 0380 - FCBA
Water-vapour permeability	Wet cup 20 μ Dry cup 30 μ	EN 13986+A1 / Table 9
Formaldehyde emission	E1	CTB-AIR + EN 120
Content of pentachlorophenol	PCP ≤ 5 ppm	-
Release of other dangerous substances: - VOC* emissions (Decree No 2011-321) - CMR 1&2** emissions (Decree No DEVPO910046A)	Classe A+ < 1 μ g/m ³	ISO 16000
Breaking strength	NPD	-
Slipperiness	NPD	-
Thermal conductivity (W/m.K)	0.15	EN 13986+A1 / Table 11
Durability - Internal cohesion (traction resistance) - Thickness expansion - Moisture resistance - Biological durability	> 1.4 N/mm ² > 13% Classe 1	EN 326-1 EN 335

N/A: Not Applicable

*VOCs: Volatile Organic Compounds

**CMR 1&2: Carcinogenics, Mutagens or Reproductive toxin of 1 and 2 category

The performance of the product identified above is in conformity with the set of declared performance/s. This declaration of performance is issued, in accordance with Regulation (EU) No 305/2011, under the sole responsibility of the manufacturer identified above.

Signed for and behalf of the manufacturer by: Carole François - Chairman

Bourgbarré, January 27th 2026

Carole FRANÇOIS

